

Practical Manual on **Geomatics**

FNR 319 3(1+2)

Dr. Pavan Kumar

2020



**College of Horticulture & Forestry
Rani Lakshmi Bai Central Agricultural University
Jhansi-284003**

Syllabus:

Preparation maps; Visual interpretation of satellite imagery; Forest cover mapping and land use mapping. Digital image processing. Introduction to various GIS software – Q-GIS, ERDAS, Arc GIS etc. Exercises in viewing, editing, overlay. Visit to the GIS labs at State level.

Name of Student.....

Roll No.

Batch.....

Session.....

Semester.....

Course Name:

Course No. :

Credit.....

Published: 2020

No. of copies:

Price: Rs.

©RLBCAU, Jhansi

CERTIFICATE

This is to certify that Shri./Km.ID
No.....has completed the practical of
course.....course No. as per the
syllabus of B.Sc. (Hons.) Forestry semester in the year.....in the respective lab/field of
College.

Date:

Course Teacher

INDEX

Ex. No.	Title	Page No.	Remarks
1	Introduction to ERDAS Imagine software		
2	To import NRSC Satellite Data		
3	To download various satellite data from open source web link		
4	To displaying various band combination of satellite image data		
5	To Geo-Referencing of Topo-Sheet and image		
6	To stacking and de-stacking of satellite data		
7	To subset of satellite data		
8	To resolution merge of various satellite data		
9	To displaying stretch satellite data		
10	To supervised classification of satellite data		
11	To unsupervised classification of satellite data		
12	To filtering of satellite data		
13	To zonal change detection of Bundelkhand region		
14	To familiarization with GIS Software Installation, Sample Data, starting and Stopping QGIS		
15	To creation of various shape file using Arc GIS		
16	To viewing, editing, overlay using Arc GIS		
17	To map composition of various feature class using Arc GIS		
18	To forest cover mapping of Bundelkhand region using Sentinel-2A/Landsat satellite data		
19	To Land use and land cover mapping of Jhansi region using Sentinel-2A satellite data		
20	To viewing handheld GPS and their function		
21	To creation point map of various building, farm, hostel and staff quarters at Rani Lakshmi Bai Central Agricultural University using handheld GPS		
22	Visit to GIS lab at state level		
	Annexure		

Practical No. 3

Objective: To download various satellite data from open source web link.

Material Required:
.....
.....

Procedure:
.....
.....
.....
.....
.....
.....
.....
.....
.....
.....
.....
.....
.....
.....
.....
.....
.....
.....
.....
.....
.....
.....
.....
.....
.....
.....
.....
.....
.....
.....
.....
.....
.....
.....
.....
.....
.....
.....
.....
.....
.....
.....
.....
.....
.....
.....
.....
.....
.....
.....
.....
.....
.....

Practical No. 4

Objective: To displaying various band combination of satellite image data.

Material Required:

.....
.....

Procedure:

.....
.....
.....
.....
.....
.....
.....
.....
.....
.....
.....
.....
.....
.....
.....

Observations:

.....
.....
.....

Satellite	FCC Band combination	NCC combination	Band	Pseudo combination
Landsat				
LISS-III				
Sentinel-2A				
MODIS				
SPOT				

--	--	--	--

Procedure-Image to image:

Observations-Toposheet:

GCC	LAT	LONG	RMSE
1			
2			
3			
4			

.....

Practical No. 7

Objective: To subset of satellite data.

Material Required:

.....

.....

Procedure:

.....

.....

.....

.....

.....

.....

.....

.....

.....

.....

.....

.....

.....

.....

.....

.....

.....

.....

.....

.....

.....

.....

.....

.....

.....

.....
.....
.....
.....

LU/LC type	DN-Value (No stretch)	LUT-Value (No stretch)	DN-Value (Linear stretch)	LUT-Value (Linear stretch)
Water bodies				
Fallow land				
Settlement				
Forest				
Barren land				

.....
.....
.....
.....
.....
.....
.....
.....
.....
.....
.....

Discussion and Conclusion:

.....
.....
.....
.....
.....
.....
.....
.....
.....
.....
.....
.....
.....
.....
.....
.....
.....
.....
.....
.....
.....
.....

LU/LC type	LAT/Long-1	LAT/Long-2	LAT/Long-3	LAT/Long-4	LAT/Long-5	LAT/Long-6
Water bodies						
Fallow land						
Settlement						
Forest						
Barren land						

Spectral Profile:

Observations:

.....

.....

Class	Recode value	New value

.....

.....

.....

.....

.....

Histograms equalization:

.....

.....

.....

.....

.....

.....

.....

.....

.....

.....

.....

.....

.....

.....

.....

.....

.....

.....
.....
.....
Discussion and Conclusion:

Objective: To filtering of satellite data.

Material Required:

.....

Procedure:

.....

.....

.....

.....

.....

.....

.....

.....

.....

.....

.....

.....

.....

.....

.....

.....

.....

.....

.....

.....

.....

.....

.....

.....

.....

.....
Observations:
.....
.....
.....

Feature class	Filter-1	Filter-2	Filter-3	Filter-4

.....
.....
.....
.....
.....
.....
.....
.....
.....

Discussion and Conclusion:
.....
.....
.....
.....
.....
.....
.....
.....
.....
.....
.....
.....
.....
.....
.....

Objective: To zonal change detection of Bundelkhand region.

Material Required:

.....

.....

Procedure:

.....

.....

.....

.....

.....

.....

.....

.....

.....

.....

.....

Observations:

.....

.....

Particulates	
Sentinel-2A	
Scale	
Band combination	
Temporal Resolution	
Spatial Resolution	
Year	

.....

.....

.....

.....

.....

.....

.....

.....

.....

.....

.....
.....
.....

Methodology Chart:

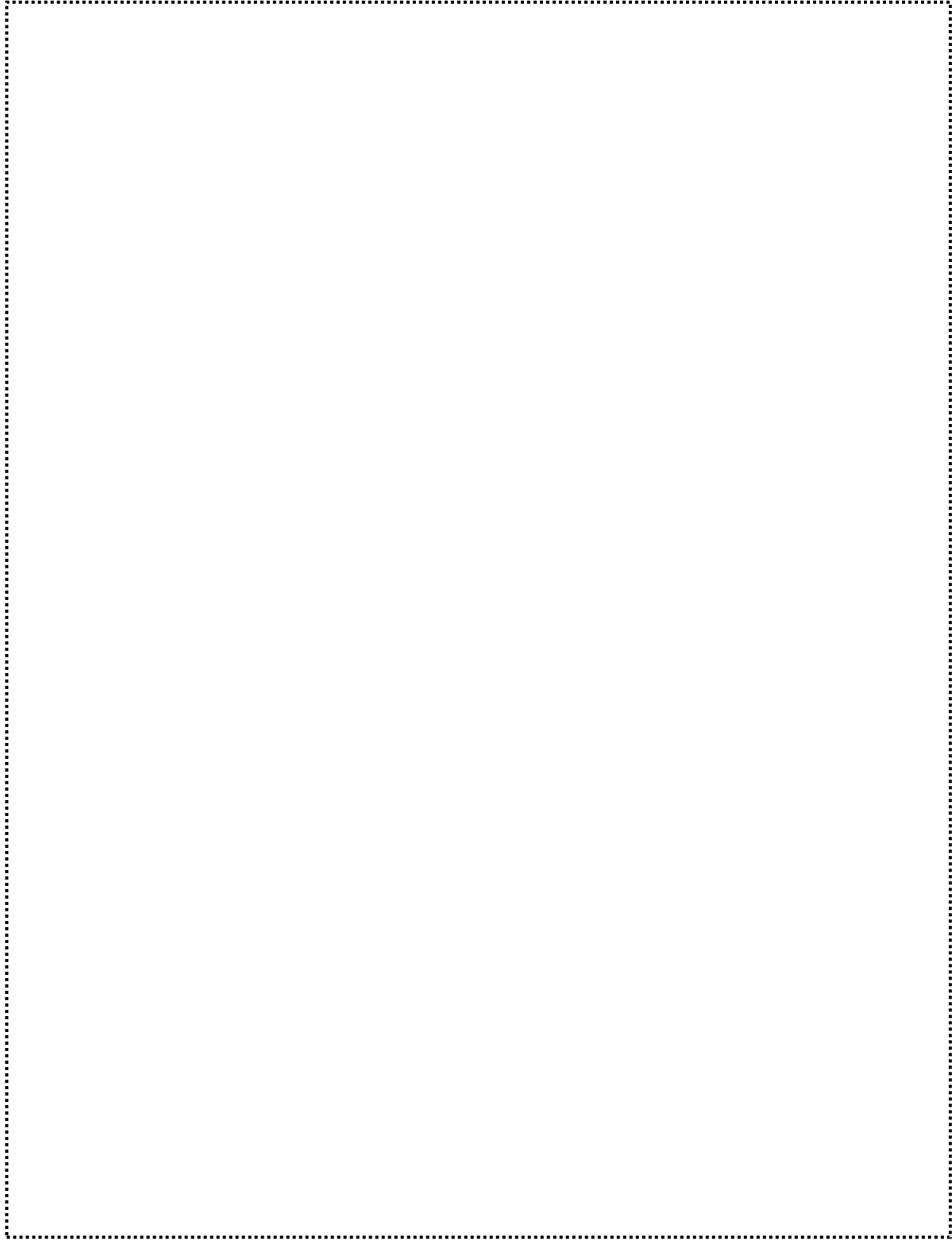

.....
.....
Discussion:

.....

Class	Lower limit	Upper limit	Frequency	Cumulative frequency	Remarks
1					
2					
3					
4					
5					
6					
7					
8					
9					
10					
11					
12					
13					
14					
15					
16					

.....
.....

Statistical Parameter

.....

Parameter	Value	Remarks
Actual maximum		
Mean		
Standard deviation		

.....
.....

Dotted lines for writing.

Discussion:

Dotted lines for writing.

Objective: Familiarization with GIS Software Installation, Sample Data, starting and Stopping QGIS.

Material Required:

Procedure:

Observations:

.....
.....
.....
.....
.....
.....
.....
.....
.....
.....
.....
.....
.....
.....
.....
.....
.....
.....
.....
.....
.....
.....
.....
.....
.....
.....
.....
.....
.....
.....
.....
.....
.....
.....
.....
.....
.....
.....
.....
.....
.....

Observations:
.....
.....
.....
.....
.....
.....
.....
.....
.....
.....
.....
.....
.....
.....
.....
.....
.....
.....
.....

.....

Observations:

.....

Practical No. 18

Objective: To forest cover mapping of Bundelkhand region using Sentinel-2A/Landsat satellite data.

Material Required:

Procedure:

Practical No. 19

Objective: To Land use and land cover mapping of Jhansi region using Sentinel-2A satellite data.

Material Required:

Procedure:

.....

.....

Observations:

.....

.....

Class	Area
Water bodies	
Settlement	
Forest	
Agriculture	
Barren land	
Fallow land	

.....

Discussion:

.....

.....

.....

.....

.....

.....

.....

.....

.....

.....

.....

.....

.....

.....

.....

.....

.....

.....

.....

Practical No. 21

Objective: To creation point map of various building, farm, hostel and staff quarters at Rani Lakshmi Bai Central Agricultural University using handheld GPS.

Material Required:

Procedure:

.....

.....

.....

.....

Observation:

.....

.....

Location	LAT	LONG

.....

Practical No. 22

Objective: Visit to GIS lab at state level.

Material Required:

.....

Observation:

.....

.....

.....

.....

.....

.....

.....

.....

.....

.....

.....

.....

.....

Report:

Notational Conventions

Bold Italicized Text: Any text, which is bold, indicates a *filename*, or *parameter* to be changed or selected.

Graphics: To help you locate icons and objects used in the exercises, the icons will be next to the icon name in the text.

Insets: These italicized captions will appear in the outside margin of the page. They define terms or explain theory behind the steps you are being asked to perform.

Diagrams: These are an optional means to direct you in the usage of some of the application's tools.

The following graphics are also used for particular purposes:

Windows Terminology

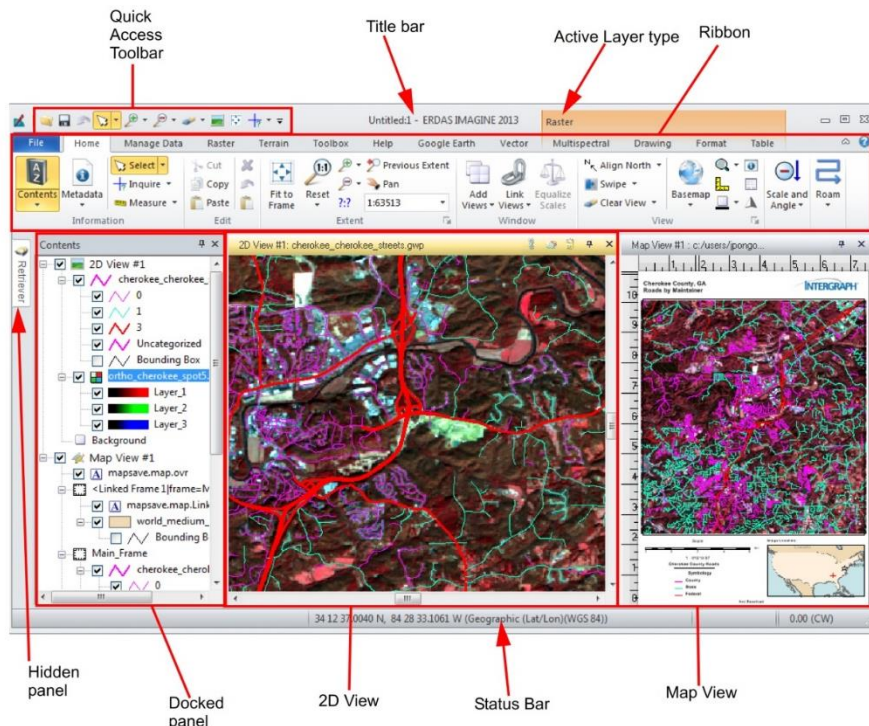
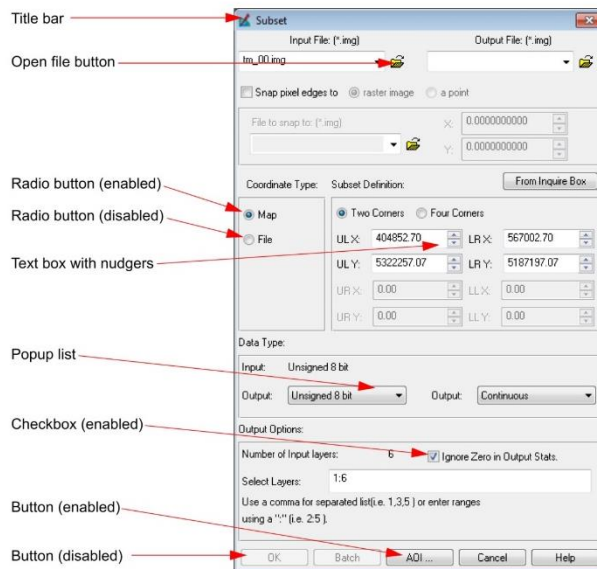

The Ribbon Explained

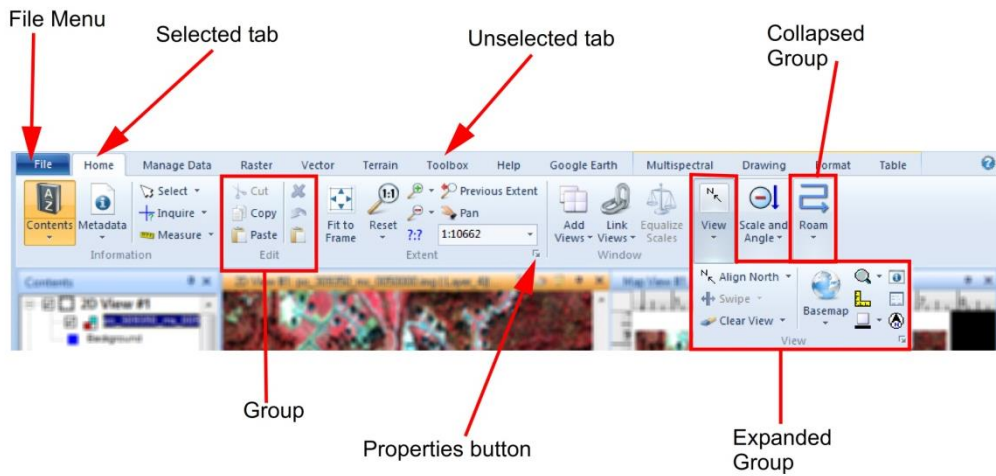

Erdas Imagine Interface Terminology

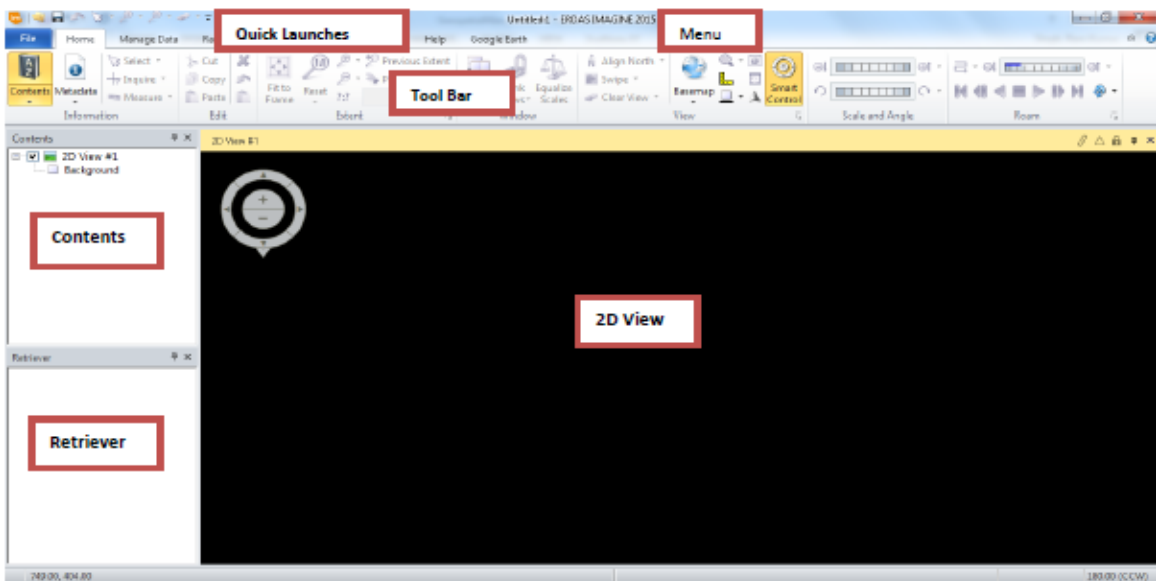

Mouse Conventions

LMB Left Mouse Button
 RMB Right Mouse Button
 MMB Middle Mouse Button